

Cutwork Rag Quilt

Supplies

Created by Amanda Whitlatch

- Bernina CutWork Accessory & Software
- Download: Rag Quilt Design Files
- BERNINA Sewing & Embroidery Machine
- BERNINA Quilting Foot #29
- BERNARTEX Bali Rainbow Flannel -
Jumbo Hoop: 1- 14"x20" and 1-12"x14"
Oval Hoop: 1- 11"x14" and 1- 7"x9"
- Quilt Batting -
Jumbo Hoop: 1 - 9" square
Oval Hoop: 1 - 6" square
- Black Isacord Embroidery Thread
- Black OESD Bobbinfill
- OESD HydroStick Tear Away Stabilizer - Cut to fit under the hoop.



Embroider - Cut - Stitch

1. Load design, and thread machine with black embroidery thread and black Bobbinfill. Embroider with Quilting Foot #29.
2. Hoop larger piece of flannel (face down) and place the piece of quilt batting in the center of the hoop, and smooth down.
3. Place hoop on machine and stitch **Color 1 (Batting Basting)**.
4. Trim batting to about 1/4 inch from the stitching line.
5. Place second piece of flannel (face up) over the top of the trimmed quilt batting, and stitch out **Color 2 (Quilt Design.)**
6. Stitch **Color 3 (Outline Stitch)** This designates the seam line.
7. Place a piece of HydroStick Tear Away Stabilizer under the hoop. (Leave dry - do not moisten.)
8. Stitch **Color 4 (Basting - Stabilizer)**
9. Remove Needle from machine and replace it with the Cutwork Tool. Rotate tool to **Position 1** and stitch **Color 5**.
10. Move Cutwork Tool to **Position 3** and **Stitch Color 6**.
11. Move Cutwork Tool back to **Position 1** and **Stitch Color 7**.
12. Remove finished Block from hoop.
13. Trim away inner basting stitch.
14. Stitch Blocks together using the Outline Stitch as a guide.



Step 2

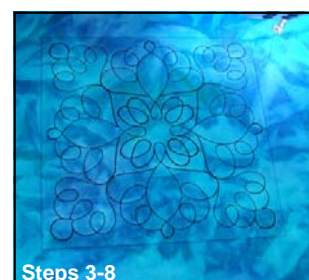

Steps 3-8



Step 14

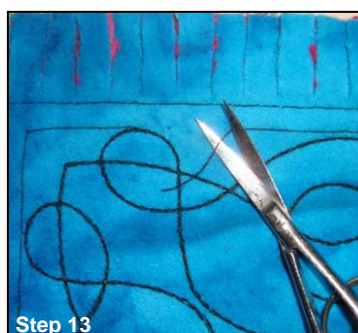

Step 13

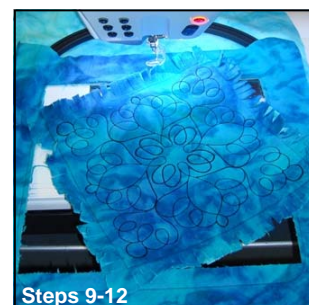

Steps 9-12

Visit
www.berninausa.com
for additional
CutWork Lessons