

Quilter's Creative Touch

Select and Sew Pattern

- From the Main Menu
- Touch **Pattern** under the “*Select & Sew*”.

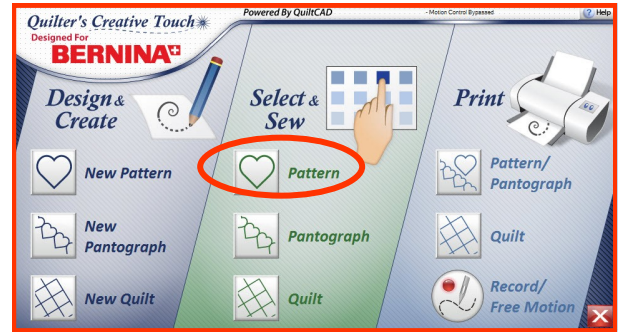

- In the pattern selection screen
- Touch **daisy.leaves.gpf** from menu of patterns.

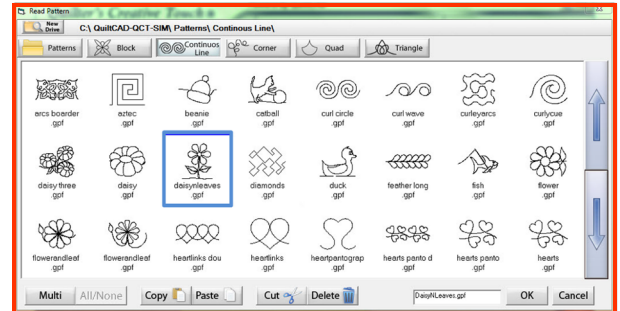

- Set safe area by bringing machine to the top left hand corner of fabric area.
- Touch “Top Left” icon on screen.

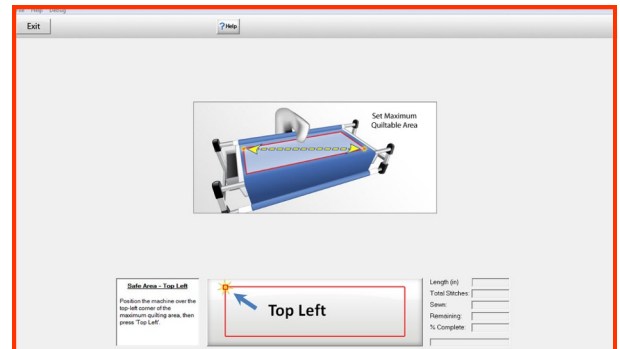

- Continue setting safe area by bringing machine to the bottom right corner of fabric area.
- Touch “Bottom Right” icon on screen.

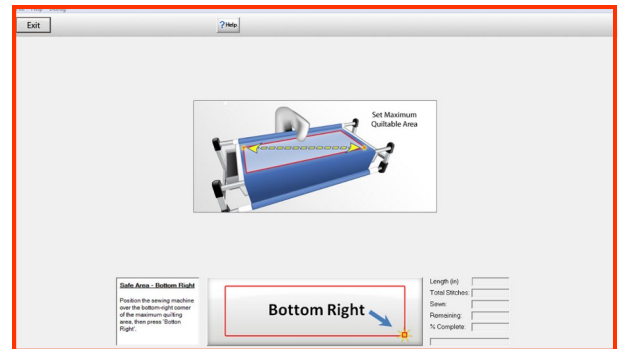

- Place the Pattern for Sewing
 - Block/Stretch is an easy placement and fill method as you only need to select an upper left corner and lower right corner. This sets the height and width of your block.

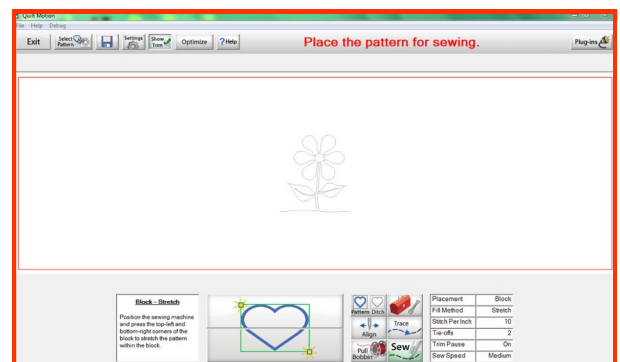

Quilter's Creative Touch

Select and Sew Pantograph

- From the Main Menu
- Touch **Pantograph** under **Select & Sew**

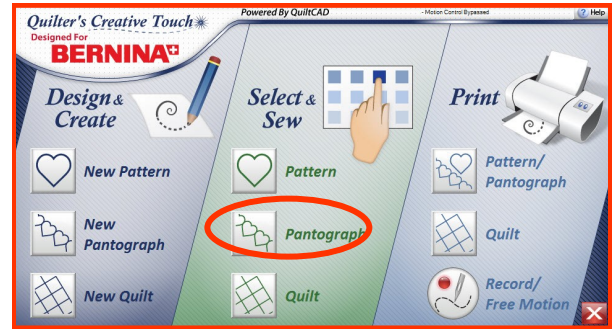

- In the pattern selection screen, touch **diamonds.gpf**.

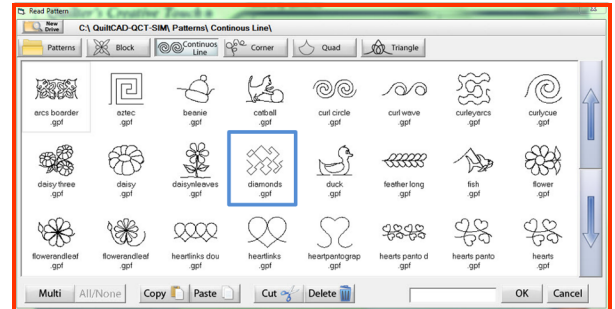

- From the lower tool bar select "Nesting" (default setting).



- Select "Set Width" and then select 24 from the pop up calculator > OK.

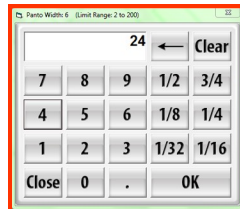

- Select the **+** icon until the Count is 3.

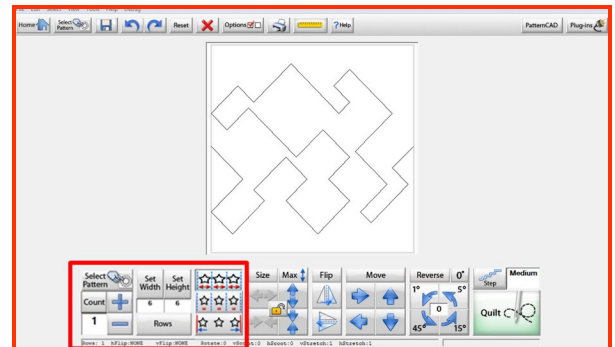

- Select Quilt in the lower right hand corner of the screen.

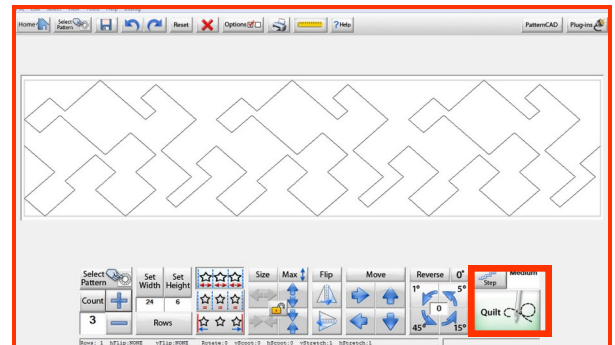

- Place the Pattern.

- A One Point/Start Point placement and fill is very simple—but placement method and fill type can be your choice.

