

## QuiltMotion Touch for BERNINA

# PantoStacker Continuous Line Designs

Created by Denise Jones

Use **QuiltMotion Touch for BERNINA** to create a continuous line design. Then use the design in **PantoStacker** for unique quilted effects.

## Supplies

### Machine & Accessories

- BERNINA 8 Series or 7 Series Sewing Machine
- BERNINA Quilting Frame
- QuiltMotion Touch Software for BERNINA



### Creating a new design:

- Open **QuiltMotion Touch** and then click “**New Pantograph**” under “**Design & Create.**”

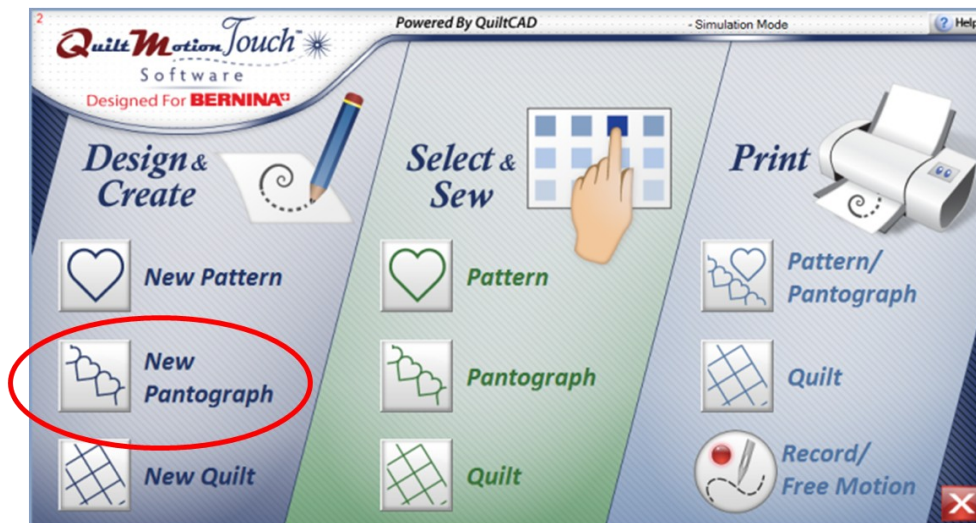

- Set “**Safe Area**” if prompted to set it.

- Make sure that “**Advanced**” is selected under select **PantoStacker Mode**.

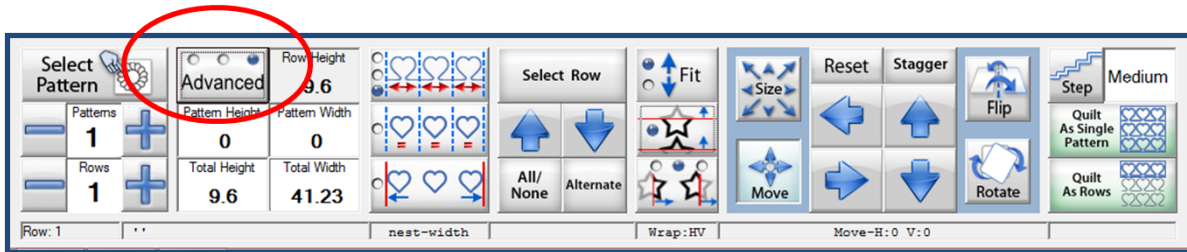

- Change “**Patterns**” to 3.
- Change “**Rows**” to 4.
- Change “**Pattern Height**” to 3.2.
- Make sure “**Step**” is on “**Medium.**”

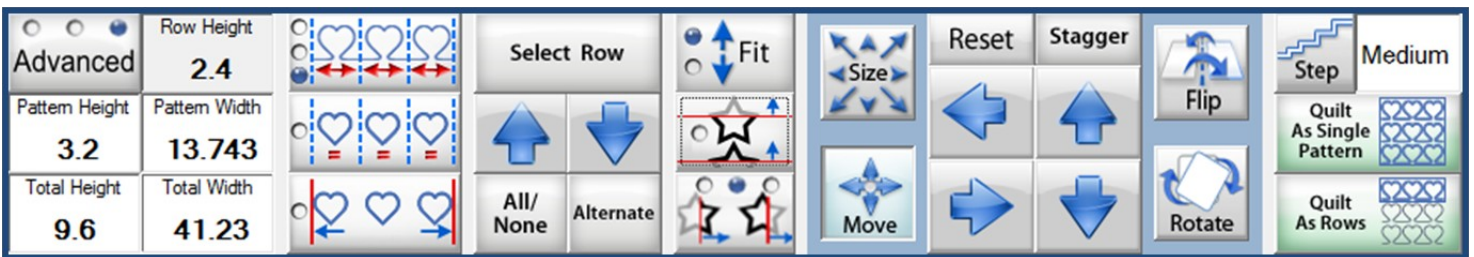
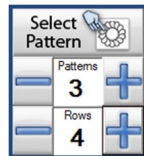

- Select all rows.
- Using “**Select Pattern**” navigate to “**Continuous Line**” folder.
- Select **SingleWave.gpf** design and open.
- Only the top row will have all three designs.

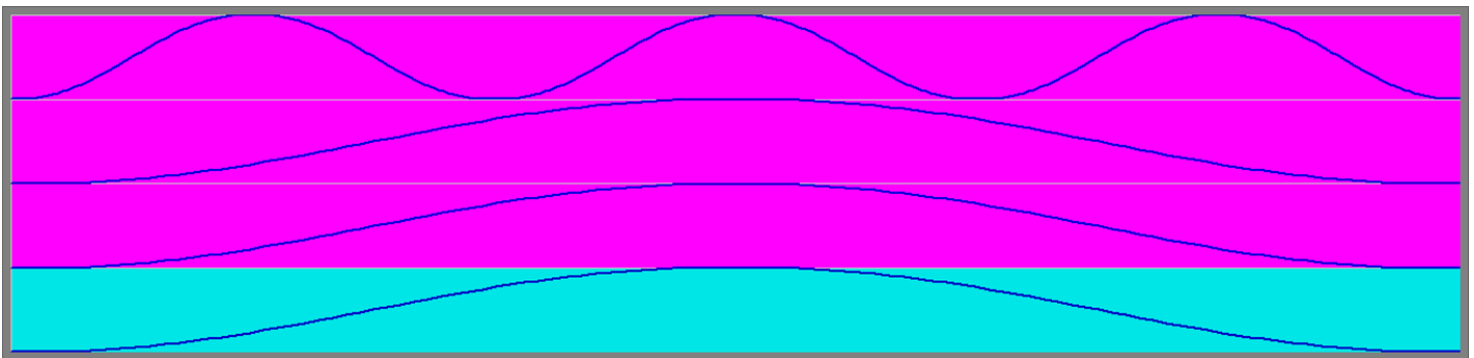

- Select “**All/None**” until **NO** rows are selected.
- Select only the three rows at the bottom with one design in each and change “**Patterns**” to 3.
- Make sure “**Pattern Height**” is 3.2.
- Select “**Alternate**” until the second and fourth rows are selected.
- Select “**Flip**” and click “**Flip Vertical**” one time, the dot should be in the second spot.

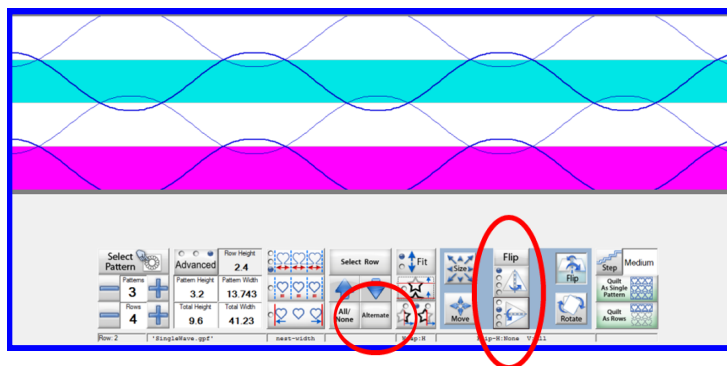

- Using the “All/None” deselect all rows.
- Working from top to bottom select the last three rows and “Move” until you like the way it looks.
- Deselect row 2 and “Move” last two rows.
- Deselect Row 3 and “Move” last row to match the others.

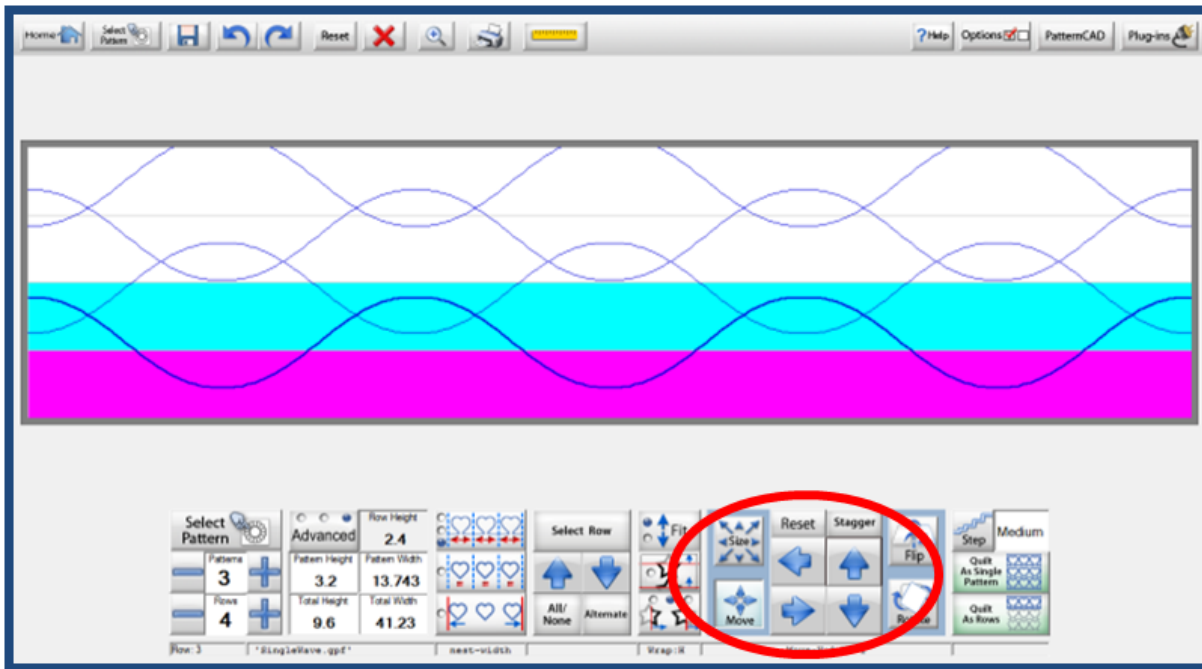

- Save your design and use in PantoStacker if desired.