

eBook
SERIES

Just QUILT It!
BERNINA
Stitch Regulator

- ~ Why the BERNINA
Stitch Regulator?
- ~ BSR Soles
- ~ Attaching the BSR
- ~ BSR Screens
- ~ BSR Modes 1 and 2



© 2015 BERNINA of America

BERNINA Stitch Regulator

The BERNINA Stitch Regulator, also known as the BSR, is an innovative accessory, far beyond a regular presser foot. Part of a dynamic interaction between quilter, accessory and BERNINA sewing machine, the BSR, after extensive development and testing, was patented as a unique innovation that is still unparalleled today.

The BSR has several features that are easy to learn and are covered in this eBook:

- Why the BERNINA Stitch Regulator?
- BSR Soles
- Attaching the BSR
- BSR Screens
- BSR Modes 1 and 2



Why the BERNINA Stitch Regulator?

The hallmark of excellence in free-motion techniques is the ability to keep the stitch length even and consistent as the fabric is guided without the assistance of the feed dog. The BERNINA Stitch Regulator provides beginners with the confidence to master increasingly popular free-motion techniques. For more experienced free-motion stitchers, the BERNINA Stitch Regulator offers the added security of consistent stitch length, providing the confidence to try more challenging techniques.

The BERNINA Stitch Regulator works with 8 Series, 7 Series, and 5 Series models. It comes as a standard presser foot with some models and is available as an optional accessory for others. All models equipped with the BERNINA Stitch Regulator offer straight stitch and some also have a zigzag stitch selection for the BSR.



Free-motion Straight Stitching

Free-motion Zigzag Stitching



BSR Soles

The BERNINA Stitch Regulator #42 has three interchangeable soles. Easy to change, these soles make it easy to sew a wide range of free-motion techniques, offering variety and versatility in the final stitched results.

Three Interchangeable Soles

Closed Metal Sole—For detailed free-motion stitching techniques such as stippling, bobbin play, and thread painting. It is similar to the BERNINA Darning Foot #9 and the BERNINA Embroidery Foot #15, both of which are used by many quilters.

Open Metal Sole—For added visibility in front of needle. Good for following printed or marked lines. The “prongs” of this sole are slightly curved, facilitating movement over several layers of fabric and/or thread. It resembles the Free-motion Embroidery Foot #24.

Clear Sole—This sole resembles Echo Quilting Foot #44. It is perfect for echo quilting and for doing medium- to large-scale free-motion stitching techniques. The large sole moves easily over raised areas; useful for stitching thick battings, as it compresses a larger area around the needle, increasing visibility. Cross-hairs and concentric circle markings aid in accurate stitch placement, especially useful when echo stitching.

Changing the Soles

1. Press in the white notch on each side of the foot, releasing the sole. Pull down and forward to easily remove the sole from the foot.
2. Place the U-shaped ends of the sole to be attached over the lower peg as shown.
3. Slide the sole up and back until it snaps into place.



Attaching the BSR

The BERNINA Stitch Regulator is attached to the machine in a two-step process: attaching the foot and connecting the cable to allow the sensor on the foot to work with the electronics of the machine to regulate stitches.

The Stitch Regulator is attached to a BERNINA BSR-compatible machine just like any other BERNINA foot:

- Lift the lever at the back of the attachment area.
- Place the connection point of the foot up onto the "cone."
- Pull the lever down to tighten the connection and hold the foot in place.

After attaching the foot, the Stitch Regulator is then plugged into the machine.

Some models have an outlet on the back of the machine and some models have one under the head frame in the back left corner.

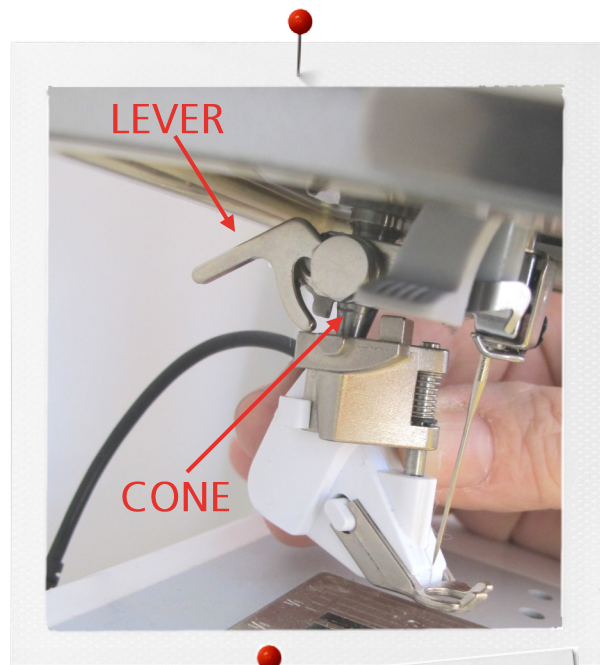

Click for Video!

BSR Screens

When the BERNINA Stitch Regulator is attached, a special screen will appear. The look of this screen may vary depending on the model of BERNINA machine you have, but the functions on screen are the same. All BSR functions are shown on the screen and must be selected there to “talk” to the stitch regulator.

From this screen, the following functions and stitch attributes may be selected by touching the appropriate icon on the screen:

- Straight or zigzag stitch (when available)
- Mode 1 or 2
- Beeper signal that indicates if the fabric is being moved too quickly for the BSR to regulate the stitches
- Stitch length
- Stitch width
- Needle Stop Up/Down

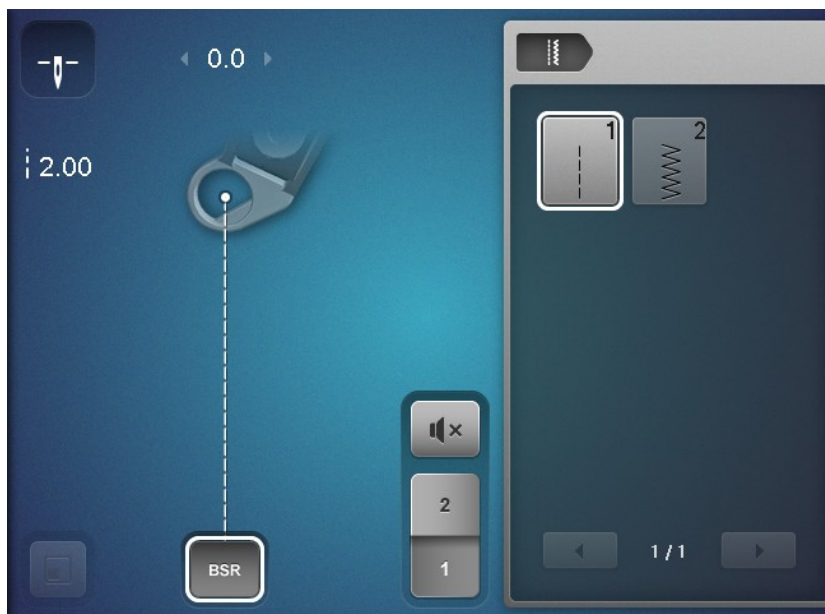
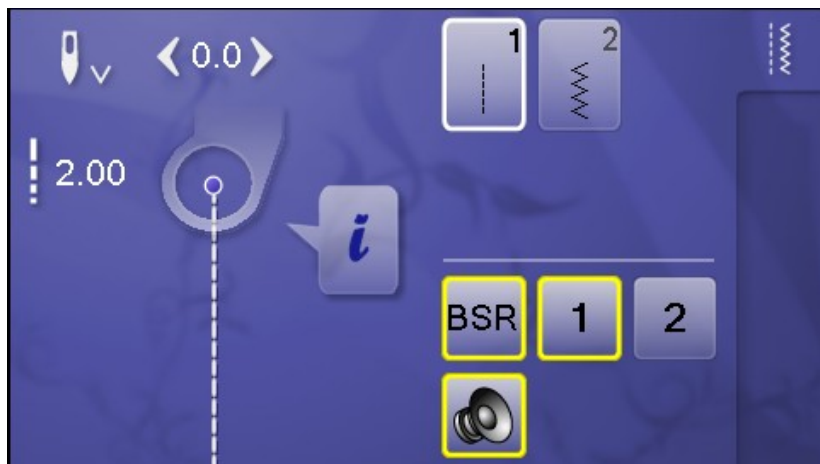

BSR Modes 1 and 2

The two modes of the BERNINA Stitch Regulator offer choices to fit the style and comfort level of the stitcher. Try both modes to find the one that works best for you.

Step 1

Select the desired mode by touching the appropriate button on the screen of the machine. The yellow outline indicates the selected mode.

BERNINA Stitch Regulator Mode 1

When BSR Mode 1 is selected, the needle immediately starts to move up and down, with or without fabric under it. This is the ideal mode for quilting points and/or corners as the needle continues to stitch when you pause at a point or corner. *Note: Before beginning to stitch in Mode 1, bring the bobbin thread to the surface of the fabric by tapping on the foot control or using the hand wheel.*

BERNINA Stitch Regulator Mode 2

When working in BSR Mode 2, the motor is engaged only when the fabric is moved under the foot, giving the stitcher time to stop and think about the path the needle is taking.



Step 2

Select the desired stitch length.

Step 3

Set the Needle Stop Up/Down function to stop with the needle in the fabric each time the power is taken away from the Stitch Regulator or at the highest position as desired.

Step 4

Power the Stitch Regulator by using the Stop/Start Button or the foot control, keeping it depressed as long as power is needed. The needle will move up and down. A red light will appear on the bottom of the Stitch Regulator foot to indicate that it is on. Move the fabric; the machine speed will be based on the speed of the fabric movement. The faster fabric is moved, the faster the machine will stitch.

Note: In either mode, the BSR automatically deactivates if there is no movement of the fabric for over 7 seconds. However, because the needle continually moves up and down in Mode 1, the machine may jam before the 7 seconds pass. To stop the Stitch Regulator, select the Stop/Start button or remove your foot from the foot control. If powering the Stitch Regulator with the Stop/Start button it may be stopped by tapping the foot control.

Step 5

Securing in Mode 1: Power the Stitch Regulator and hold the fabric in place for 3 or 4 stitches or select a very short stitch length and move the fabric very slowly for 3 or 4 stitches. Use this method at the beginning and ending of the stitches.

Securing in Mode 2: The Securing function may be used with mode 2. Select the securing function on the screen and power the Stitch Regulator. The machine will stitch in place for 4 stitches, stop with the needle up, and wait for the fabric to be moved.

