

# Imperial Gardens Sampler

Created by Elaine Cibelli

Delicate blossoms blend with appliqué while dragonflies and butterflies dance in the Imperial Gardens, BERNINA's Exclusive Embroidery Collection #82008.

Explore the garden's flowers, flourishes, airy leaves, medallions and gossamer border designs to create a lovely sampler quilt. BERNINA Embroidery Software 7 makes the set-up a breeze.

58" x 37" finished



## Supplies

### Machine & Accessories

- BERNINA Sewing & Embroidery Machine
- BERNINA Embroidery Software 7
- Jumbo Hoop, Maxi Hoop or Large Oval Hoop
- Teardrop Embroidery Foot #26
- BERNINA Stitch Regulator #42
- Echo Quilt and CutWork Foot #44C
- Triple Sole Walking Foot #50
- Leather Roller Foot #55
- Patchwork Foot with Guide #57
- CutWork Tool
- CutWork/Straight Stitch Plate
- Binder Attachment #88 and Foot #95C (38mm)

### Threads

- Isacord Thread: 0020,0453, 0643, 0870, 1860, 3650, 3820, 5934
- Yenmet Gold S-12
- Embroidery Bobbin thread
- Aurifil Thread for piecing

### Embroidery Design Collection

- BERNINA Exclusive Embroidery Collection - Imperial Gardens #82008

### Fabric & Notions

- 1½ yard STOF linen ST14-050
- ½ yard black linen or cotton
- 2 yards Benartex Imperial Gardens 640M-55 Border
- 2 yards Benartex Imperial Gardens 642M-55 Backing
- Assorted Fabric scraps for applique
- OESD Applique Fuse and Fix
- OESD Fuse & Fleece
- OESD Ultra Clean and Tear Away Stabilizer
- 505 Temporary Spray Adhesive
- Organ Titanium Needles - Sizes 80 for embroidery
- 75/11 Quilting needle for piecing and quilting

## General Instructions

- Fabric is prepared in advance by ironing Fuse and Fleece to the wrong side of the fabric and cut larger for embroidery. Hoop the fabric with Ultra Clean and Tear Stabilizer for embroidery. Jumbo or Maxi Hoop was used when quilting was done in the hoop.
- Appliqué pieces are prepared by ironing Appliqué Fuse and Fix to the wrong side of the fabric and cut in advance using the files included in the collection with the CutWork Tool or Scissors.
- After creating a block and inserting it into the quilt in the Quilter Application, the quilting may overlap the sashing. **SAVE OFTEN.**
- Measurements on the Quilt Layout below are the *finished* measurements. Add ½" to those measurements for trimming. All seams are ¼". See page 9 for final cutting instructions.

## Designing the Quilt



- Open the BERNINA Embroidery Software 7.
- Locate the Application Launcher and from the drop down menu, select Quilter.
- Select the Layout icon > 7 blocks across and 4 blocks down that measure 6" x 6" > 1" sashing, style - sash squares > Add 1" inner horizontal border > add 4" horizontal border. The finished quilt is 58" x 37" > Click OK > Show All.  
(See a *New Leaf Runner project on bernina.com for instructions for downloading and importing fabric swatches from benartex.com*)
- Open the Library and click on the fabrics tab. Scroll down to Imperial Gardens fabric folder > click the + sign to open.
  - ♦ Select the fabric ST14-050 hold down the CTRL key and place fabric in all blocks > click on individual sashing to fill in as shown in the layout picture.
  - ♦ Select a solid black color for the sashing.
  - ♦ Select Benartex Imperial Gardens fabric 642M-55for the border > Hold the CTRL key and click on the border.
  - ♦ Select on the Show fabric 1:1 icon > CTRL L hides the lines.
  - ♦ File > Save As > Imperial Gardens Layout.

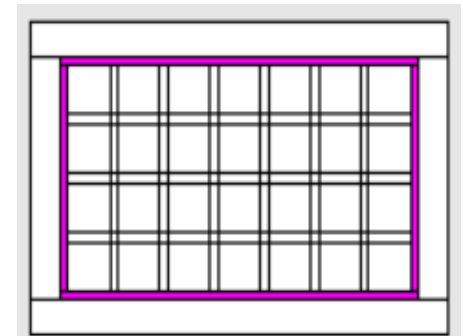
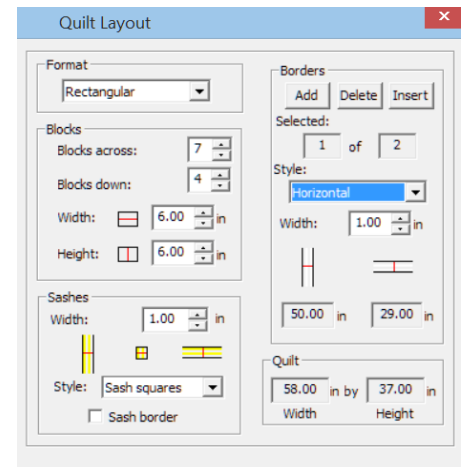
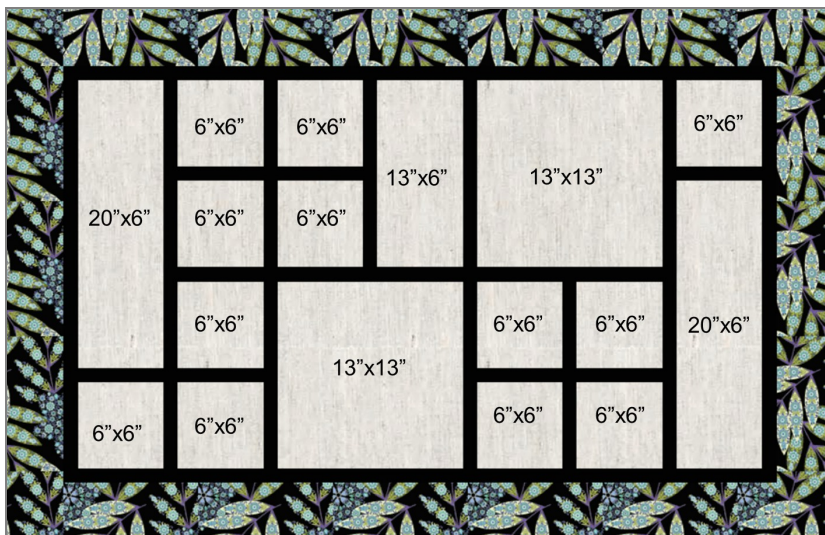

### Color Wheel

You can change the colors of the designs by moving the spokes on the Color Wheel. The circle in the center is the base color node and the controller – when that is moved all of the colors are affected. Each individual color can be changed by selecting individual nodes. The shade of the color can also be changed by sliding the Brightness control.



### Thread Colors

Select the Thread Colors icon > Select the Isacord Thread Chart > Match and Assign All. The software matches all the colors chosen in Color Wheel to the thread chart selected.



## Embroidery - Blocks



### Leaf Block 82008-42



- Select the Embroidery Window.
- When Embroidery Canvas opens, select the Insert Embroidery icon (alternately select File > Insert Embroidery). Navigate to the file Imperial Gardens > Open > Select File 82008-42 > Open > Rotate 3° > clone for a total of 3 designs > Select All (CTRL A) > In the Arrange Toolbox > align vertical centers > Group.
- To add quilting: Select the Rectangle Tool from the Digitize Toolbox and the Stipple Fill Stitch > create a rectangle measuring 20½" x 6½". Adjust to make sure they fit within the Stipple Rectangle.
- In the Edit Toolbox, select Add Holes > using the least amount of left and right clicks, digitize around each leaf (left click at the tip of the leaf, right click in the center side, left click at the other tip, right click on the other side) > Enter > do the same around each leaf in the design > clicking Enter twice at the last leaf > Save.
- Select the Hoop Canvas > Add Hoop > Arrange so the entire design turns green > select the Splitting Guide to divide the stipple > when all is green return to Embroidery Canvas.
- File > Save As > a Master file > Save again as a split file.
- File > Save and Return. Drag and drop into place in the quilt and fine tune placement using keyboard arrows.

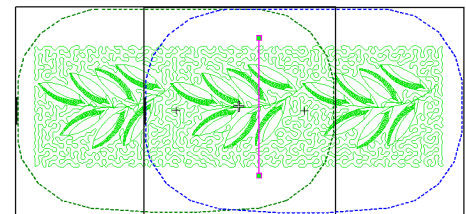

### Dragonfly Block 82008-25

*The quilting for this block will be created as a separate file, embroidered, and pieced into the quilt without the dragonfly. The dragonfly is embroidered after the quilt is pieced since it overlaps the sashing.*



- Select the Embroidery Window.
- Select the Rectangle Tool from the Digitize Toolbox and the Stipple Run Fill stitch and create a 6½" square > File > Save As Stipple Square. File > Save and Return.
- Minimize the Quilter Application to return to Embroidery Canvas.
- After the quilt is assembled with the stipple square > embroider the dragonfly > Select File 82008-25 > Open > Rotate right 45° > send to machine.



### Medallion 1 Block 82008-12



- Select the Embroidery Window.
- When Embroidery Canvas opens, select the Insert Embroidery icon (alternately select File > Insert Embroidery). Select File 82008-12 > Open.
- To add quilting: Select the Rectangle Tool from the Digitize Toolbox and Stipple Run Fill to create a 6½" square > CTRL A to select all > from the Arrange Toolbox, select Align Centers.
- In the Edit Toolbox select Add Holes > and left and right click around the design > Enter > Enter.
- File > Save and Return. Place into position on the quilt.

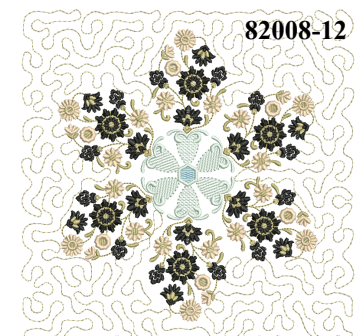



## Medallion 2 Block 82008-01



- Select the Embroidery Window.
- When Embroidery Canvas opens, select the Insert Embroidery icon (alternately select File > Insert Embroidery). Select File 82008-01 > Open.
- To add quilting: Select the Rectangle Tool from the Digitize Toolbox and Satin Outline to create a 7" square > CTRL A to select all > from the Arrange Toolbox, select Align Centers.
- In the Edit Toolbox, select Outline Design > Offset .20mm, Outline Count 6, check Outline Holes, Check Single > OK
- Hold down the CTRL key and select the Satin Stitch and all Outlines on the outside of the satin square > Delete.
- File > Save and Return. Place into position on the quilt.

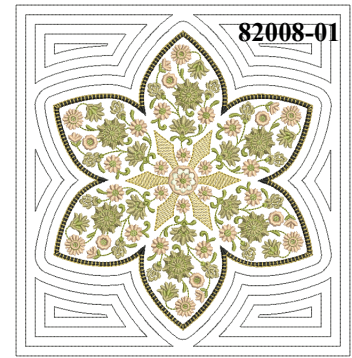

## Medallion 3 Block 82008-37



- Select the Embroidery Window.
- When Embroidery Canvas opens, select the Rectangle Tool and Ripple Fill > right click on the selected design to open Object Properties > change the Stitch Spacing to 13.mm > OK.
- Select the Insert Embroidery icon (alternately select File > Insert Embroidery). Select File 82008-37 > Open.
- CTRL A to select all > from the Arrange Toolbox, select Align Centers.
- File > Save and Return. Place into position on the quilt.

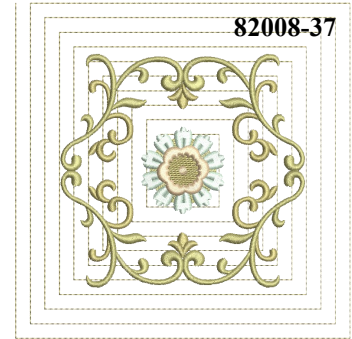

## Flower 1 Block 82008-09



- Select the Embroidery Window.
- When Embroidery Canvas opens, select the Insert Embroidery icon (alternately select File > Insert Embroidery). Select File 82008-09 > Open.
- To add quilting: Select the Rectangle Tool from the Digitize Toolbox and Blackwork Fill to create a 6½" square > Right click on the square to open Object Properties > Select > B0005a.
- Change X and Y to 1 inch then do the same for the column and row spacing > OK.
- Select CTRL A to select all > from the Arrange toolbox, select Align Centers.
- File > Save and Return. Place into position on the quilt.





## Medallion 4 Block 82008-02



- Select the Embroidery Window.
- When Embroidery Canvas opens, select the Insert Embroidery icon (alternately select File > Insert Embroidery). Select File 82008-02 > Open.
- To add quilting: Select the Rectangle Tool from the Digitize Toolbox and Satin outline to create a 6½" square > CTRL A to select all > from the Arrange Toolbox, select Align Centers.
- In the Edit Toolbox, select Outline Design > Offset .20mm, Outline Count 6, check Outline holes, check Single > OK.
- Hold down the CTRL key and select all Outlines on the outside of the satin square > delete. Select the Satin Stitch and change to Single Outline
- File > Save and Return. Place into position on the quilt.



## Flower 2 Block 82008-28



- Select the Embroidery Window.
- When Embroidery Canvas opens, select the Insert Embroidery icon (alternately select File > Insert Embroidery). Select File 82008-28 > Open.
- To add quilting: use the Rectangle Tool and a Pattern Fill to create a 6½ inch square. Send it to the start > select all > Arrange Toolbox > Align Centers.
- Select the square > Right Click to open object properties > select the Fill Stitch Tab > File Type: Pattern > Scroll to Heirloom > Select 711 > OK
- Change the Size X and Y to 1 inch and Column Spacing and Row spacing to 1 inch > OK.
- File > Save and Return. Place into position on the quilt.



## Combi-Floral Block 82008-33,35,34



- Select the Embroidery Window.
- When Embroidery Canvas opens, select the Rectangle Tool from the Digitize Toolbox and Pattern Fill to create a 6½" x 20½" rectangle > Right click on the design to open Object Properties > Select Bernina V5 > NP005-13 > OK.
- Change the Size X to 1.68"inch and Y to 1.44 inch and Column Spacing to 1.68 and Row spacing to 1.44 inch > OK.
- Insert Embroidery icon (alternately select File > Insert Embroidery). Select File 82008-33 > Open > Mirror Horizontal > Insert Embroidery > 82008-35 and place it just below and slightly touching design33 > Insert Embroidery >82008-34 moving it just below 35 > Hold down the CTRL key and select the 3 designs Select the Arrange Toolbox > Align Vertical Centers > Group
- CTRL A to select all > from the Arrange toolbox select align centers.
- File > Save and Return. Place into position on the quilt.







## Medallion 5 Block 82008-22



- Select the Embroidery Window.
- When Embroidery Canvas opens, select the Insert Embroidery icon (alternately select File > Insert Embroidery). Select File 82008-22 > Open > Select the Jumbo Hoop #26.
- To add quilting: Select the Rectangle Tool from the Digitize Toolbox and Stipple Run Fill to create a 13½” square > right click to open Object Properties > change the Loop Spacing to .75 inches > OK.
- CTRL A to select all > from the Arrange Toolbox, select Align Centers.
- Select the Hoop Canvas > Add Hoop > Arrange so the entire design turns green > select the Splitting Guide to divide the stipple > when all is green return to Embroidery Canvas.
- File > Save and Return. Place into position on the quilt.

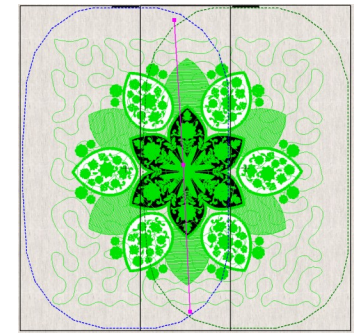
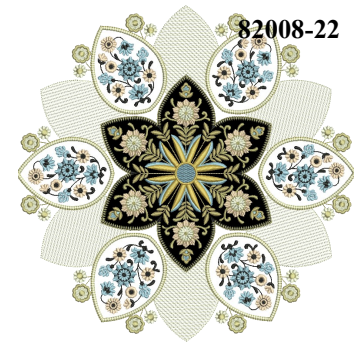

## Combi-Leaf Block 82008-19,21,32



- Select the Embroidery Window.
- When Embroidery Canvas opens, select the Insert Embroidery icon (alternately select File > Insert Embroidery). Select File 82008-19 > Open > Select the Mirror Merge Toolbox > Wreath > change the spin box to 6 > Hold down Ctrl to constrain the line to 45° angles > click to set > rotate 90°
- Select Insert Embroidery > navigate to design 82008-21 > open > move the design so that it is centered between the top two petals > Select the Mirror Merge Toolbox > keep the spin box at 6 > click to set.
- Select Insert Embroidery > navigate to design 82008-32 > open > move it to the side > Arrange > Ungroup > use the Polygon Select Tool to isolate the largest motif and move it to the center of the created design >
- Select the small flower on the right and place it in the design as shown. Select the Mirror Merge Toolbox > Wreath > change the spin box to 12 and arrange as shown.
- To add quilting: Select the Rectangle Tool from the Digitize Toolbox and Satin Outline to create a 13½” square.
- In the Edit Toolbox, select Outline Design > Offset .20mm, Outline Count 6, check Outline holes, Check Single > OK.
- Hold down the CTRL key and select the satin stitch and all outlines on the outside of the satin square > delete.
- File > Save and Return. Place into position on the quilt.

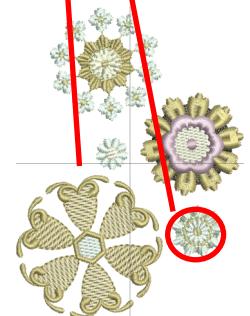
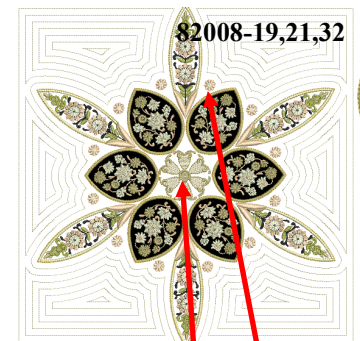
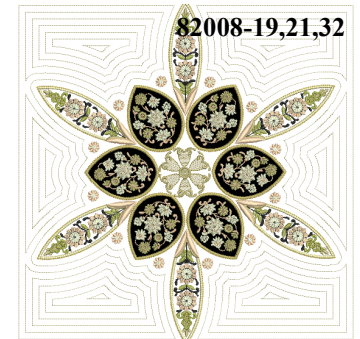



## Butterfly Block 82008-24



- Select the Embroidery Window.
- When Embroidery Canvas opens, select the Insert Embroidery icon (alternately select File > Insert Embroidery). Select File 82008-24 > Open
- To add quilting: Select the Rectangle Tool from the Digitize Toolbox and Blackwork Fill to create a 6½" square > right click to open Object Properties > B0060a >OK > Change the Size X and Y to .57inch and Column Spacing and Row spacing to .57 inch > OK.
- CTRL A to select all > from the Arrange Toolbox, select Align Centers.
- File > Save and Return. Place into position on the quilt.



## Mini-Medallion Block 82008-31



- Select the Embroidery Window.
- When Embroidery Canvas opens, select the Insert Embroidery icon (alternately select File > Insert Embroidery). Navigate to the file Imperial Gardens > Open > Select File 82008-32 > Open.
- Use the Rectangle Tool and a Step Fill to create a 6½ inch square. Send it to the start > Select All > Arrange Toolbox > Align Centers.
- Select the square > Right Click to open object properties > select the Fill Stitch Tab > File Type: Pattern > Scroll up to Bernina V5 > NP005-13 > click OK. Change Size X to 1.26" or 32mm > Size Y to 1.08" or 27.42mm Column spacing to 1.26" and Row spacing 1.08 > OK.
- File > Save and Return. Place into position on the quilt.

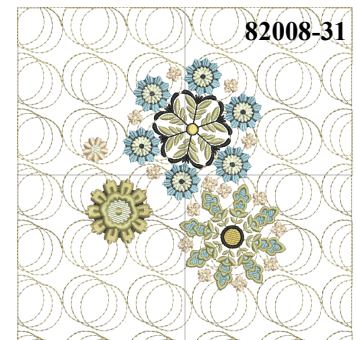

## Flower 3 Block 82008-05



- Select the Embroidery Window.
- When Embroidery Canvas opens, select the Insert Embroidery icon (alternately select File > Insert Embroidery). Select File 82008-05 > Open.
- To add quilting: Select the Rectangle Tool from the Digitize Toolbox and Satin Outline to create a 9" square > CTRL A to select all > from the Arrange Toolbox select Align Centers.
- In the Edit Toolbox, select Outline Design > Offset .20mm, Outline Count 6, check Outline holes, Check Single > OK.
- Select and change the size of the satin stitch to 6½" as a guide.
- Hold down the CTRL key and select all outlines on the outside of the satin square > delete. Select the Satin stitch and change to Single Outline.
- File > Save and Return. Place into position on the quilt.

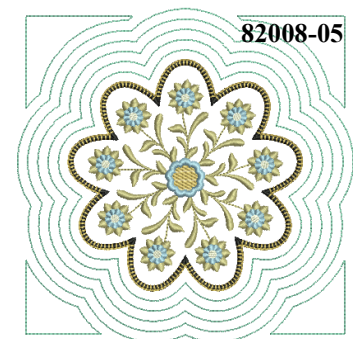

W: 6.50 in  
H: 6.50 in



## Flower 4 Block 82008-08



- Select the Embroidery Window.
- When Embroidery Canvas opens, select the Insert Embroidery icon (alternately select File > Insert Embroidery). Select File 82008-08 > Open.
- To add quilting: Select the Rectangle Tool from the Digitize Toolbox and the Stipple Run Fill Stitch and create a 6½” square File > CTRL A to select all > from the Arrange Toolbox, select Align Centers.
- File > Save and Return. Place into position on the quilt.



## Flower 5 Block 82008-26



- Select the Embroidery Window.
- When Embroidery Canvas opens, select the Insert Embroidery icon (alternately select File > Insert Embroidery). Select File 82008-26 > Open.
- To add quilting: Select the Rectangle Tool and Single Outline to create a 6½” square.
- CTRL A to select all > from the Arrange Toolbox, select Align Centers.
- Select the Open Freehand Tool from the Digitize Toolbox and Single Outline to create squiggles.
- File > Save and Return. Place into position on the quilt.

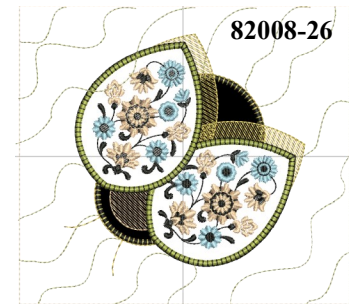

## Multi-Medallion Block 82008-40



- Select the Embroidery Window.
- When Embroidery Canvas opens, select the Insert Embroidery icon (alternately select File > Insert Embroidery). Select File 82008-40 > Open.
- Clone for a total of 4 designs > Select All (CTRL A) > In the Arrange Toolbox > Align Vertical Centers > Edit > Group.
- To add quilting: Select the Rectangle Tool from the Digitize Toolbox and the Stipple Fill stitch > create a rectangle measuring 20½” x 6½”. Adjust to make sure the designs fit within the stipple rectangle.
- In the Edit Toolbox, select Add Holes > using three right clicks (see diagram) > Enter > do the same around each design > clicking Enter twice at the last design.
- Select the Hoop Canvas > Add Hoop > Arrange so the entire design turns green > select the Splitting Guide to divide the stipple > when all is green return to Embroidery Canvas.
- File > Save As > a Master file > Save again as a split file.
- File > Save and Return. Drag and drop into place in the quilt and fine tune placement using keyboard arrows.

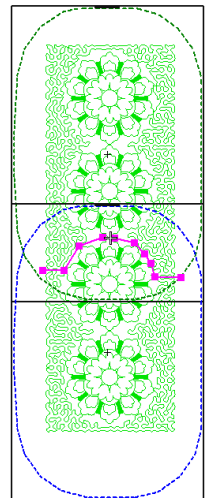
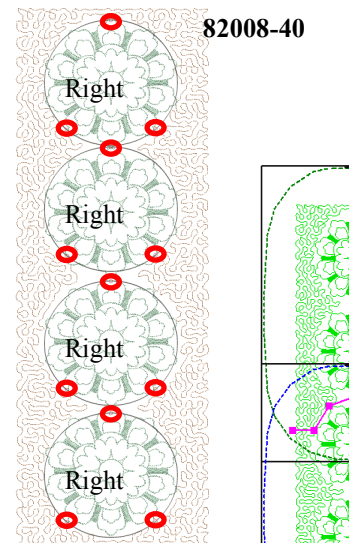



## Finishing the Quilt

- Trim the blocks:
  - ◆ square blocks trimmed to 6½" x 6½"
  - ◆ Center top block trimmed to 6½" x 13½"
  - ◆ Long blocks trimmed to 6½"x20½"
  - ◆ Jumbo blocks trimmed to 13½"x13½"
- Cut black fabric sashing strips and inner border:
  - ◆ Cut 8 strips - 1½" x 6½" block sashing
  - ◆ Cut 3 strips - 1½" x 13½" sashing for 13½" blocks
  - ◆ Cut 6 strips - 1½" x 27½" inner vertical sashing and side inner border.
  - ◆ Cut 2 strips - 1½" x 50½" top and bottom inner border.
- Cut 2 strips - 4¼" x 27¼" side borders.
- Cut 2 strips - 4¾" x 55¼" Top and bottom borders.
- Use Patchwork Foot with Guide #57 for construction.
- Layer Backing, batting and quilt top > Secure by stitching in the ditch around each block and down the center of the sashing > Quilt the border and bind as desired.



**Visit [bernina.com](http://bernina.com)**

*Projects • Webinars • Promotions*