

Embroidery
ProjectDivine Flowers & Vines
Pink Power Quilt

Created by Linda Wenturine



Finished size: approximately 44" x 56"

We all love flowers for their beauty and color. The Pink Power Quilt pattern is the perfect backdrop for OESD's Divine Flowers and Vines Embroidery Collection. Ah... so gorgeous, and what a masterpiece! Green thumb optional.

Featuring OESD's Divine Flowers & Vines Embroidery Collection...



Supplies

Machine & Accessories

- BERNINA Sewing & Embroidery Machine
- Patchwork Foot #37/37D
- BERNINA Stitch Regulator or your favorite free-motion presser foot
- Mega Hoop and template or your largest embroidery hoop
- BERNINA Embroidery Software 6 (optional)

Embroidery Collections

- OESD's Divine Flowers and Vines - Crafter's Collection #1102
- OESD's Quilting Whimsy - Crafter's Collection #007

Fabric & Notions

- Pink Power quilt pattern by Blue Underground
- Pink Purpose Silk Collection by Brewer
- 3½ yards of fabric for backing and binding

- 8 yards of white ArmoWeft fusible interfacing
- Low-loft cotton batting, twin size
- OESD Ultra Clean & Tear stabilizer
- 101 Quilt Basting Spray
- Organ Embroidery needles, size 75/11
- Microtex needles, size 80/12
- Isacord Embroidery thread (see page 2 for colors)
- Rainbows (color 832) variegated thread by Superior Threads
- Thread for quilt construction
- Bobbin thread
- Hand-sewing needle
- Rotary cutting equipment
- Nifty Notions "Cut for the Cure" ruler
- Target Stickers
- X-ACTO knife for slashing velvet stitches
- Master Hooper[®] — a life-saver!

Construct the Quilt

- Prepare the silk fabric by fusing ArmoWeft interfacing to the back of each fat quarter.
- Cut out silk following the pattern instructions.
- Construct the quilt top following the pattern instructions. You will not need all of the rectangle units for the 44" x 56" quilt shown, which is only 16 rows across (it is the same length as the one in the instructions). You can use all of the rectangle units if you desire—your quilt will just be slightly wider than the one shown.
- Using a hand-sewing needle, sew a line of long basting stitches through the center of the quilt from top to bottom, then a line through the center from side to side. Next baste from each corner to the center of the quilt. These basting lines will be used as guides for positioning the designs.



Embroider the Quilt

- Print templates for these designs:
 - BE110215—five copies
 - BE110210—twelve copies
 - BE110212—eight copies
 - BE110222—four copies
- Position the templates on the quilt and arrange according to the embroidery layout guide on page 3, or as desired.

TIP: Layout the designs using BERNINA Embroidery Software, then print templates of the finished groupings.

- Start the embroidery process with the center wreath. Replace each template with a target sticker.



- Cut a piece of Ultra Clean & Tear stabilizer large enough to hoop. Spray it with 101 Quilt Basting Spray and affix it to the back of the fabric where the embroidery design will be stitched. Hoop the fabric/stabilizer together in the Mega Hoop.

TIP: Use the Master Hooper[®] as an aid for trouble-free hooping!

Isacord Thread Color Replacement Chart	
Color on Chart	Color Used on Quilt
0722	0352
1565	6133
4752	2520
4332	2521
1761	1352
3654	1911
0643	0651

Pink Power Quilt Layout Guide

- Lay out the five rose design BE110215 templates in the center of the quilt until you obtain a nice wreath arrangement.
- Place three trailing vine design BE110210 templates from one corner toward the center, positioning them over the hand-basting lines. Repeat for the remaining three corners.
- Arrange the eight rose design BE110212 template around the center wreath.
- Position two floral motif BE110222 templates at the center of each side of the quilt.

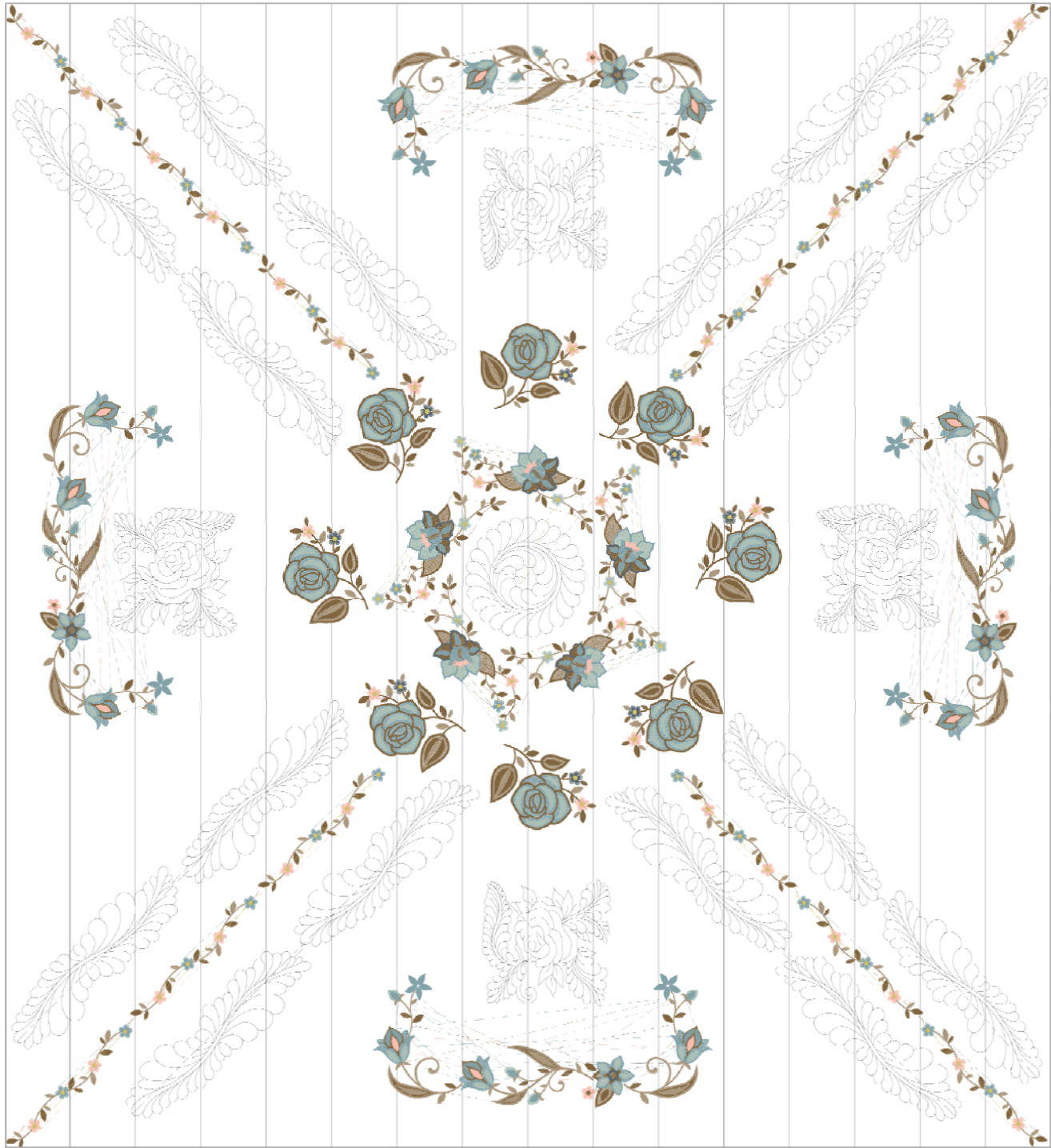

- If your embroidery machine has a built-in basting box, use it to baste around each embroidery design before stitching. You may also download basting box files at www.bernausa.com > See It, Share It > FREE Downloads > Other Cool Stuff.
- Remove the hand-basting stitching before embroidering, as it may be difficult to remove later.
- Embroider each design in the center wreath, removing the target sticker before stitching.

TIP: If using a BERNINA 830, change the presser foot height (in the embroidery settings) to 7.5mm; this allows for the extra height of the “velvet” stitches. Alternatively, decrease the presser foot pressure on other machine models.

- Embroider the trailing vines (design BE110210) from the corners toward the center.

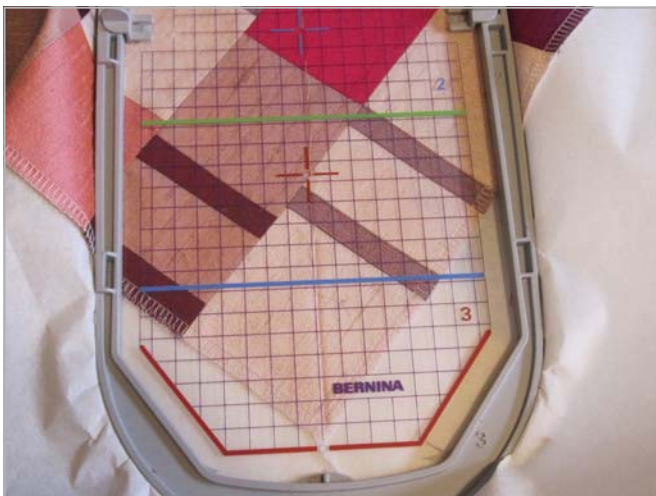

- Embroider the outer ring of eight roses (design BE110212).



- Embroider the center top, bottom, and side designs.

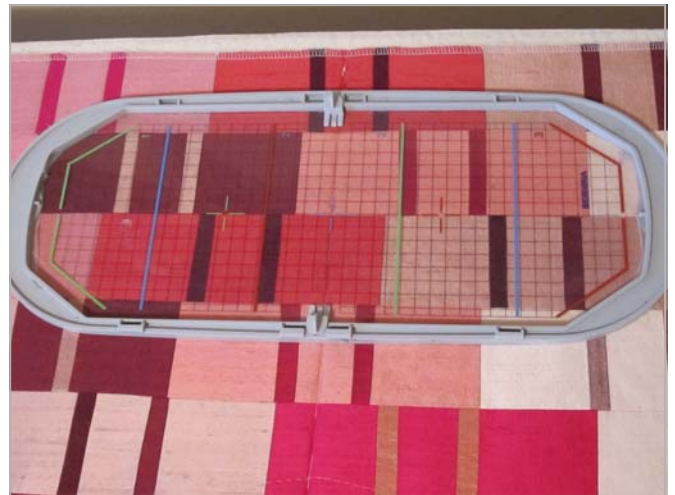

- When all embroidery is complete, remove the hand-basting stitches and basting boxes (if you used them), and clip the jump stitches.

Construct the Quilt

- Cut six 2½”-wide strips for the binding. (Cut the binding along the crosswise grain, not the bias, of the fabric.)
- Use the remaining fabric for the quilt back. You will have to cut and join the fabric to make a large enough piece for the back. Make sure the back is 2” larger than the quilt top all the way around.
- Cut the batting the same size as the backing.
- Layer the quilt back, batting, and top together, adhering the layers together with 101 Quilt Basting Spray.
- Pin baste the layers of the quilt, starting in the middle and working out to the sides.
- Open Quilting Whimsy design BC00704. Increase the size by 140% to fit inside the center wreath. Print a template of the enlarged design.
- Print templates for these designs:
 - BEC00704—four copies
 - BEC00720—one copy
 - BEC00731—sixteen copies

- Position the templates on the quilt and arrange according to the embroidery layout guide on page 3, or as desired. Pin templates in place.



- Using Rainbows variegated thread color 832 in both the needle and the bobbin, embroider each design, replacing each template with a target sticker. Be sure to remove target stickers before stitching each design.



- Attach the BERNINA Stitch Regulator or your favorite free-motion presser foot to the sewing machine. Using Isacord thread color 1352 in the needle and bobbin, stipple quilt the remainder of the quilt.



- Trim the edges of the quilt as needed, squaring the corners and sides.
- Sew the binding strips together and bind the quilt using your favorite binding method.
- Carefully slice the “velvet” stitching areas following the instructions included with the Divine Flowers and Vines embroidery collection.



Visit www.bernausa.com

Projects • Webinars • Promotions